

QUANTITY SUMMARY

Description	Unit	Total Units
Poles/Mast Arms		
Signal Pole/Mast Arm/		
Foundation/Hardware to be removed	EA	1
Signal pole to be installed. Height = 20'	EA	1
Mast Arm to be installed, Length = 44'	EA	1
Signal pole foundation to be installed	EA	1
Traffic Cabinet		
None		
Mounted Items		
Section signal heads (Black) with new hardware	EA	13
3 Sections Backplates (Yellow)	EA	3
4 Sections Backplates (Yellow)	EA	1
Pedestrian signal heads	EA	2
Pedestrian push button	EA	1
ASOLOCBL 60 Harness	EA	1
Pelco Astro Sign Mount AS-0144	EA	1
Remove/Re-install Econolite Autoscope Video Detector	EA	1
Remove existing sign & install new sign supplied by City	EA	1
Cable, Conduit, & Junction Boxes		
2" PVC (if needed)	LF	20
#8 AWG EGC	LF	50
3M 138	LF	200
14/4C	LF	200
#10AWG	LF	150

POLE LOCATION

NORTHING	EASTING
3392755.14	11222871.42

SIGNALS

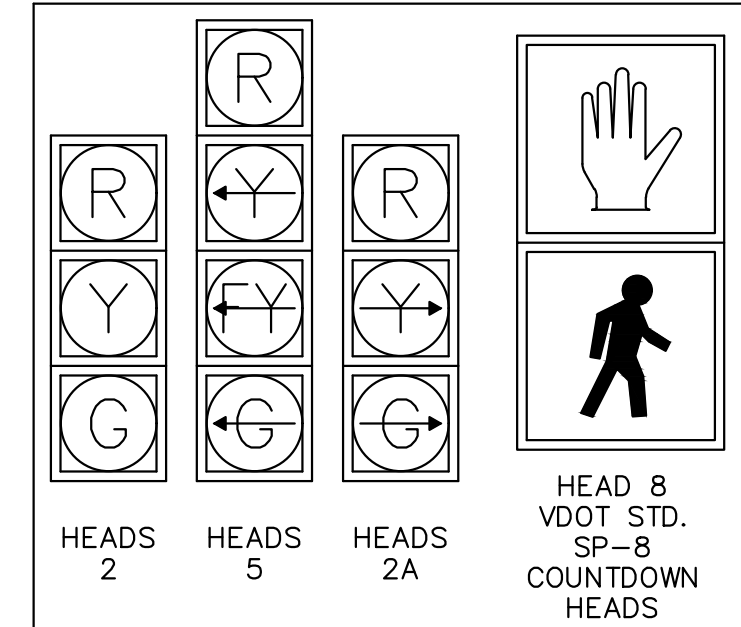

SIGNS

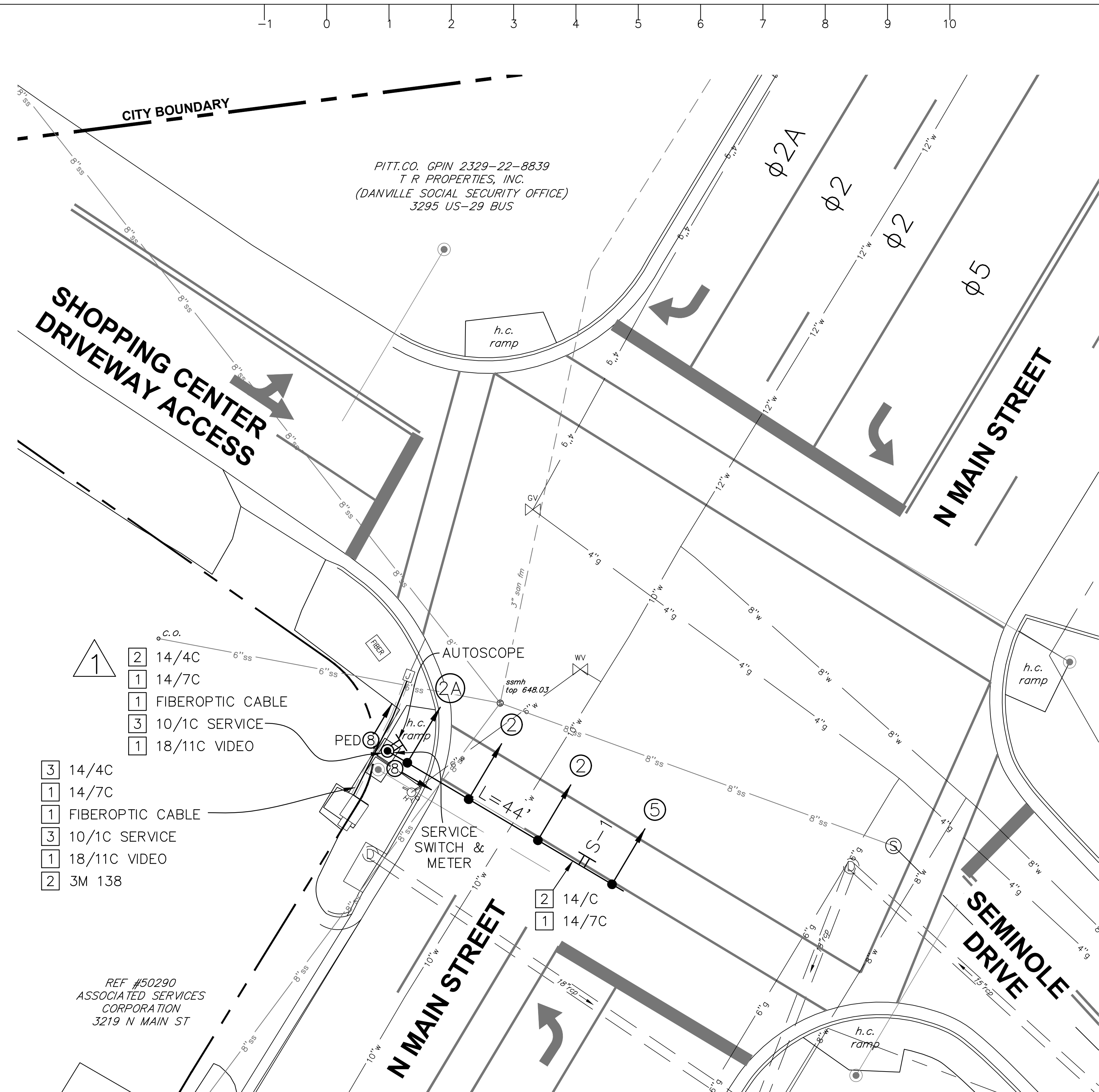
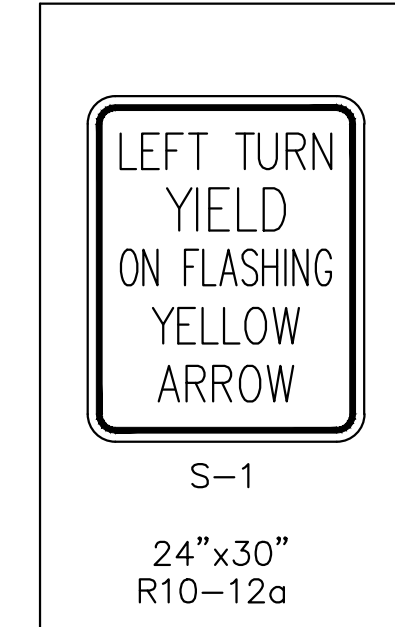

- 1 14/4C
 - 1 14/7C
 - 1 FIBEROPTIC CABLE
 - 3 10/1C SERVICE
 - 1 18/11C VIDEO
-
- 3 14/4C
 - 1 14/7C
 - 1 FIBEROPTIC CABLE
 - 3 10/1C SERVICE
 - 1 18/11C VIDEO
 - 2 3M 138

REF #50290
ASSOCIATED SERVICES CORPORATION
3219 N MAIN ST

PITT.CO. GPIN 2329-22-8839
T R PROPERTIES, INC.
(DANVILLE SOCIAL SECURITY OFFICE)
3295 US-29 BUS

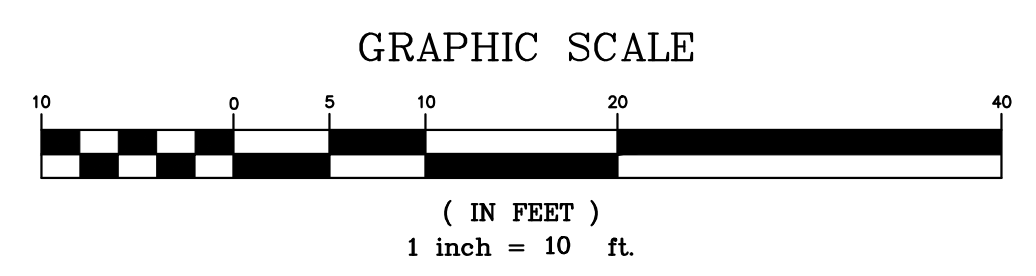

PLANS	BY	DATE
DESIGNED	KAB	5/21/19
CHECKED	KAB	5/21/19
RED LINE	N/A	

CITY OF DANVILLE, VIRGINIA
OFFICE OF THE CITY ENGINEER
427 PATTON STREET
DANVILLE, VA 24541
434-799-5019

NOTES

- A. GENERAL**
- THE SIGNAL INSTALLATION SHALL CONFORM TO THE PROVISIONS OF THE MANUAL OF UNIFORM TRAFFIC CONTROL DEVICES, THE VDOT ROAD AND BRIDGE STANDARDS AND THE VDOT ROAD AND BRIDGE SPECIFICATIONS TOGETHER WITH THE LATEST SPECIAL PROVISIONS AND COPIED NOTES IN EFFECT AT THE TIME OF APPROVAL BY THE CITY OF DANVILLE.
 - POLE PLACEMENT SHALL BE VERIFIED BY THE CITY ENGINEER PRIOR TO CONSTRUCTION.
 - CONTRACTOR SHALL PROVIDE ALL TRAFFIC CONTROL.
 - USE EXISTING CABINET AND EXISTING JUNCTION BOXES AND CONDUITS.
- B. POLES AND FOUNDATIONS**
- MAST ARM POLES ARE TO BE BLACK STD. MP-1 WITH HAND HOLE AND TERMINAL STRIPS IN BASE OF POLE. POLE #1 SHALL HAVE A SHAFT LENGTH OF 20 FT. SEE SPECIFICATIONS FOR DETAILS.
 - ALL ANCHOR BOLTS SHALL BE COVERED.
 - MAST ARM LENGTHS ARE TO BE AS SHOWN ON PLANS.
 - THE CONTRACTOR SHALL FURNISH THE POLE FOUNDATION DESIGN. THESE FOUNDATIONS SHALL INCLUDE ALL REQUIREMENTS OF STD. PF-1.
 - PROVIDE CONDUIT MARKS ON ALL FOUNDATIONS AT BASE OF POLES.
 - FROM BASE TO EACH SIGNAL HEAD SHALL HAVE 4C OR 7C CABLE. EACH SIGNAL HEAD SHALL BE WIRED SEPARATE FROM THE TERMINAL STRIP AT THE BASE OF THE POLE.
- C. CONTROLLER AND FOUNDATIONS**
- THE CONTRACTOR SHALL PROVIDE, INSTALL, AND ADJUST TIMINGS TO PROVIDE AN ORDERLY FLOW OF TRAFFIC, OR AS DIRECTED BY THE CITY ENGINEER.
- D. TRAFFIC SIGNAL HEADS**
- SIGNAL HEAD SECTIONS SHALL BE BLACK 12" POLYCARBONATE WITH ALL L.E.D.S.
 - MAST ARM SIGNAL HEADS SHALL BE MOUNTED IN ACCORDANCE WITH STD. SM-3. ALL BOLTS, NUTS, AND WASHERS SHALL BE STAINLESS STEEL.
 - ALL SIGNAL HEADS SHALL HAVE LOUVERED YELLOW ALUMINUM BACKPLATES.
 - ALL LAMPS SHALL BE L.E.D. BY "DIA-LITE."
 - VISORS SHALL BE BLACK TUNNEL VISORS.
- E. VIDEO DETECTION**
- THE CONTRACTOR SHALL INSTALL ONE EXISTING ECONOLITE AUTOSCOPE SOLO PRO MVP ACCORDING TO MANUFACTURER SPECIFICATIONS.
 - WIRING FOR VIDEO DETECTION SHALL BE IN ACCORDANCE WITH MANUFACTURER SPECIFICATIONS.



THE CITY OF DANVILLE, VIRGINIA
DEPARTMENT OF PUBLIC WORKS



**N MAIN STREET @ SEMINOLE DRIVE
TRAFFIC SIGNAL POLE REPLACEMENT**

REVISIONS	BY	DATE

TRAFFIC SIGNAL PLAN		
SCALE	PLAN: 1" = 10' HOR: N/A VERT: N/A	CITY FILE NUMBER: H-930 SHEET TS-1